

PART NR.
LT56

Curved, 90°

COUNTRY OF ORIGIN
Italy

STANDARDS
REACH and RoHS compliant
ECE R7 approved

CHARACTERISTICS

- Bent 90°
- Bulb not included
- Screws not included
- Weight: 0,3 kg

PHOTO / TECHNICAL DRAWING

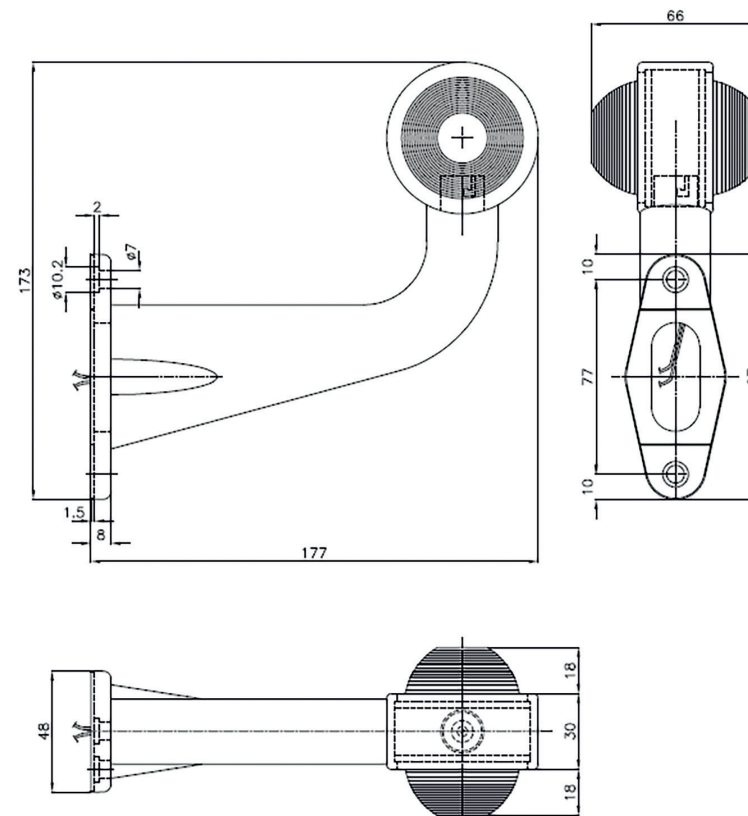

DIMENSIONS

L x W x H: 177 x 66 x 173 mm
Hole spacing: 77 mm
Rating: 12V

TECHNICAL SPECIFICATIONS

Body: Rubber, black
Lens: PMMA, red-clear
Light source: Bulb R5W (BA15s)
Mounting: M6 screws
Rating: 12V