

glassOTO GLASS FUSE - GLAF5000 SERIES

PART NR.
See rating table

COUNTRY OF ORIGIN:
France

STANDARDS:
REACH and RoHS compliant

CHARACTERISTICS

- Glass tube with copper alloy, nickel plated caps
- Marked with voltage and current rating
- Range from 1A up to 50A
- Cap enclosed solder joints

PHOTO / TECHNICAL DRAWING

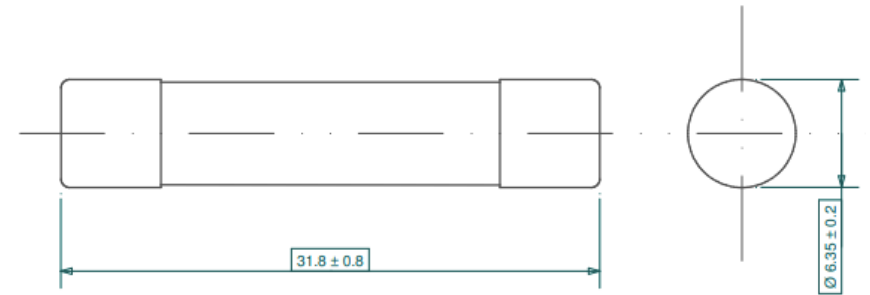

DIMENSIONS

L x Ø: 32 x 6,3 mm

RATING TABLE

Part nr.	Rating (A)	Rating (V)	Part nr.	Rating (A)	Rating (V)
GLAF5001	1	32	GLAF5015*	15	32
GLAF5002	2	32	GLAF5016*	16	32
GLAF5002.5	2,5	32	GLAF5020*	20	32
GLAF5003	3	32	GLAF5025*	25	32
GLAF5004	4	32	GLAF5030*	30	32
GLAF5005	5	32	GLAF5035*	35	32
GLAF5006	6	32	GLAF5040*	40	32
GLAF5008	8	32	GLAF5050*	50	32
GLAF5010	10	32			

* Not per standards

TECHNICAL SPECIFICATIONS

Material body:

Glass tube with copper alloy, nickel plated caps

Operating ambient temp.:

15 ~ 35 °C per standards

Cycling test:

According to IEC 127 and BS 4265